

The new standard in hospitals, assisted living facilities, medical clinics and anywhere simple room dividing privacy is needed.

We understand custom cubicle curtains are a necessity for all hospitals, clinics and medical facilities. CustomCube.com has over 40 years of experience fabricating and providing custom cubicle curtain systems per our customers specifications. At CustomCube.com, we excel in providing the best quality cubicle and privacy curtains, supplies and hardware to the healthcare industry.

InterLoc Modular Curtain System

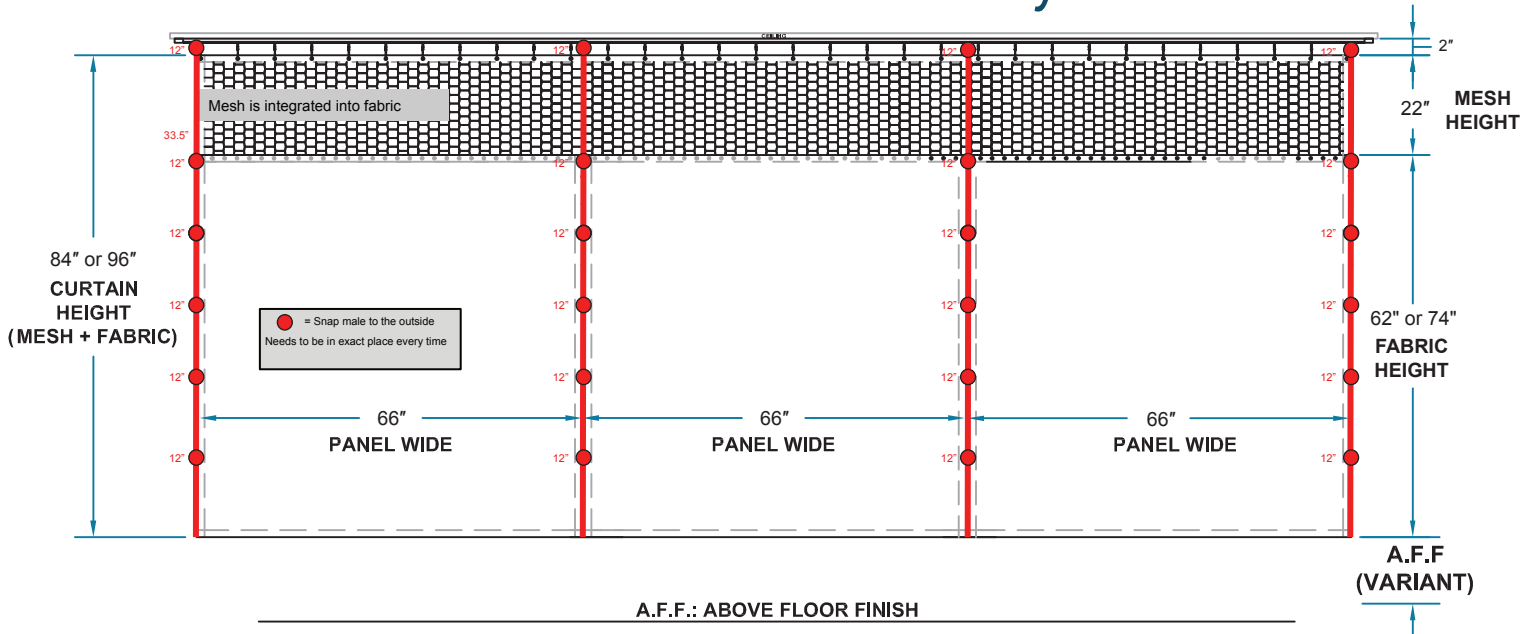

3 fabric colors to choose from



Flexible Track

Aluminum Track

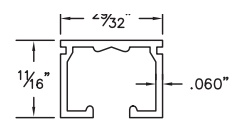
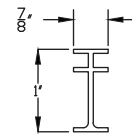

3 aluminum track colors to choose from

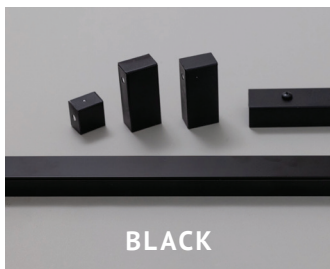
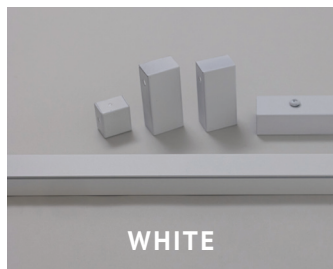

Flexible track

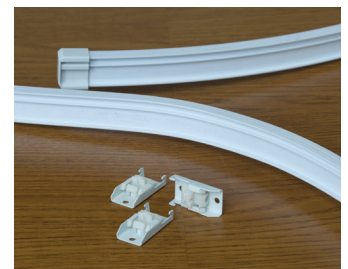

InterLoc Modular Curtain System

WIDTH

66" (167.64 cm) , including 20-22" (51-56 cm) integral mesh

CONTENTS

82.7% polyester, 17.3% polyester FR

RECYCLED CONTENT

82.7% post-consumer

REPEAT

Border print, 26" (66 cm) horizontal repeat

ABRASION RESISTANCE

ASTM D4157: 20,000 double rubs

FIRE TEST

Passes NFPA 701 (test 1, small scale) Meets NFPA 13
Sprinkler System Code: mesh openings are 70% or larger
Passes CAN/ULC-S109-14

COLORFASTNESS

AATCC-16 Colorfastness to Light: meets requirements, 60 hours
AATCC-61 Colorfastness to Laundering: test on file
AATCC-116 Colorfastness to Wet & Dry Crocking: meets requirements

ADDITIONAL TESTS

AATCC-96 Dimensional Changes in Laundering: test on file
ASTM D3512 Pilling: test on file
ASTM D434 Seam Slippage: meets requirements

MARINE GRADE SNAPS

Rustproof, nickel-plated brass grommets placed every 12" along the length of each panel to lock into one another

HEALTHIER HOSPITALS INITIATIVE (HHI)

Integral Mesh printed fabrics require 80% less water and 50% less energy to convey color, further reducing environmental impact. In accordance with HHI, integral mesh fabrics contain no formaldehyde or stain resistant finishes. Integral Mesh fabrics are free from PVC and do not include antimicrobials or intentionally added flame retardants.

WARRANTY

Material is warranted to be free of manufacturer defects for a period of one year based upon end user following recommended care instructions

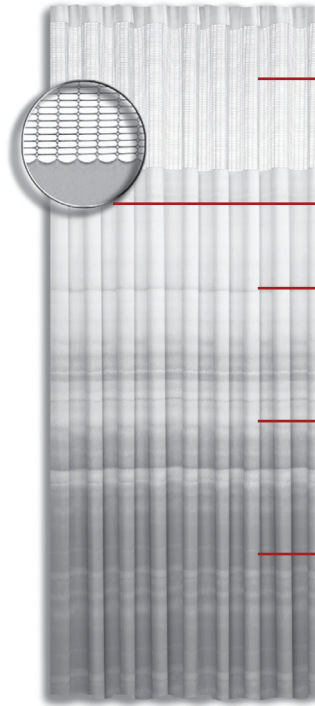

Our 4" (10 cm) fabric header triple folds to reinforce grommets and ensure strong construction.

One-piece knit construction provides continuity of color and design.

No puckering, no shrinking and no weakness will occur because of our unique, patented one-piece construction.

Our curtain, knit 102" (259 cm) wide, requires no fabric repeat or seaming, which translates to considerable cost savings.

Retaining its shape through frequent launderings, our curtain always hangs and stacks beautifully.

LAUNDRER

Ensure laundering machinery is free of burrs or sharp objects that can cause snagging. Wash with like colors. Do not combine with other products such as towels, sheets, napery, etc. Do not overload machinery. Machine wash warm (120 -160 F). Use non-chlorine bleach if needed. Do not use any fabric softeners. Dry with like colors and products. Do not overload the dryer. Tumble dry on medium (140 F). Promptly remove from dryer. Use iron on low setting if needed. test on file ASTM D434 Seam Slippage: meets requirements

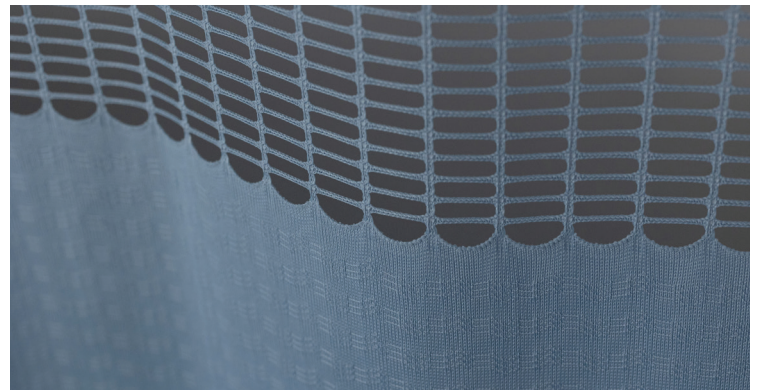

THIS FABRIC MEETS OR EXCEEDS ACT STANDARDS

