

SCITEC®

Patient room solutions.



H2000VRI

EH2000 Cradle



H2000



H2001-00



H2001-09

Healthcare Series User Guide

H2000, H2000VRI, EH2000, H2001-00, H2001-09

Table of Contents

H2000VRI Phone Map	2	Jacks	7	Industry of Canada	
H2000 Phone Map	3	EH2000	7	Requirements	9
EH2000 Cradle Phone Map	4	Bedrail Holder	7	Requirements of Part 15—	
H2001-09 Phone Map	5	H2001-09/H2001-00	7	FCC Rules	10
H2001-00 Phone Map	5	Package Contents	7	Requirements of Part 68—	
H2000VRI/H2000	6	Operation	7	FCC Rules	10
Package Contents	6	Jacks	7	Care and Maintenance	11
Installation	6	Important Safety Instructions	8	Technical Specifications	11
Attaching the Handset	6	FCC Interference Information	8	User Guides	11
Wall-Mounting	6	FCC RF Radiation Exposure	8	Service	11
Operation	6	Statement	9	Statement of Limited Warranty	11

H2000VRI Phone Map

Wall jack on underside of phone base

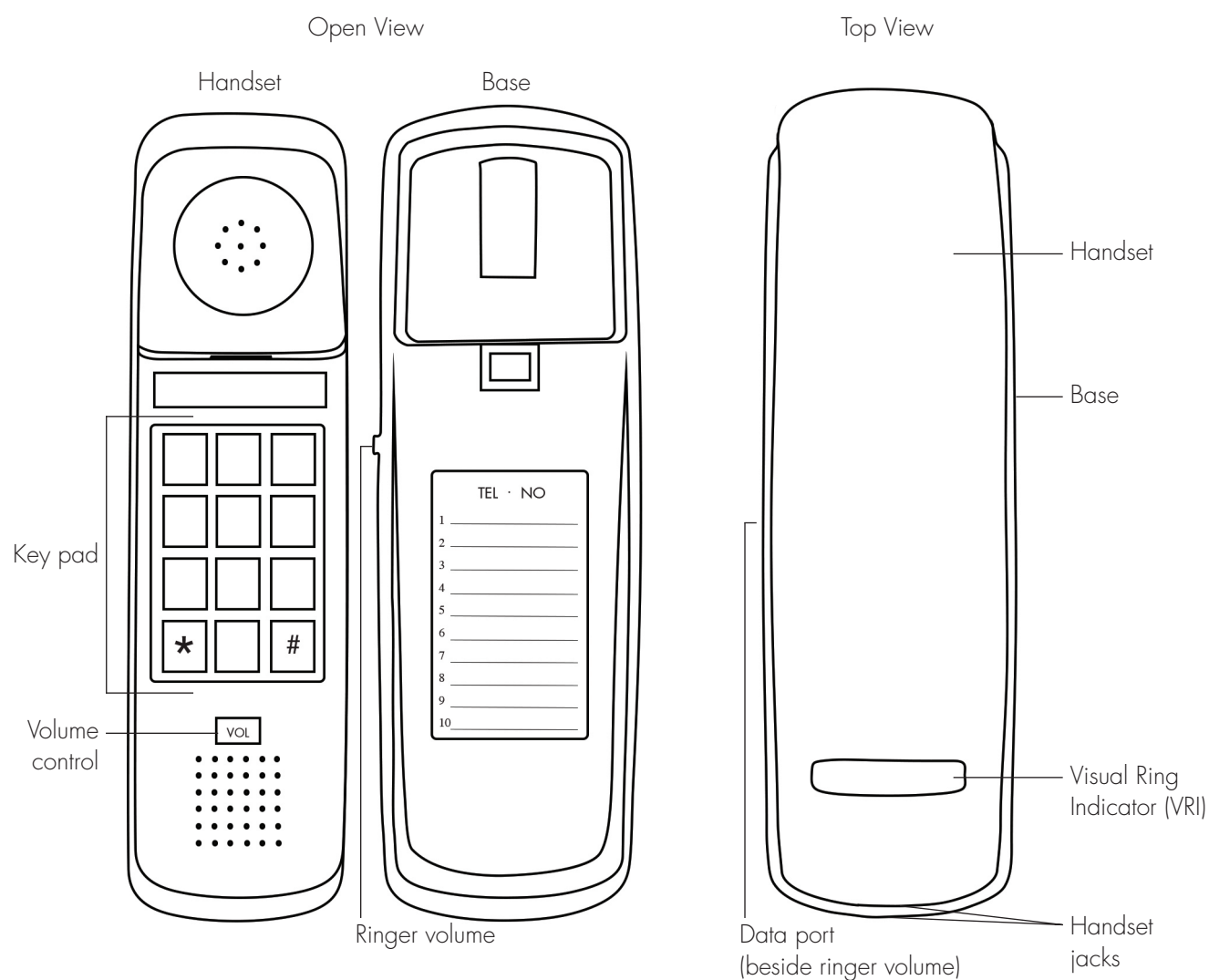

H2000 Phone Map

Wall jack on underside of phone base

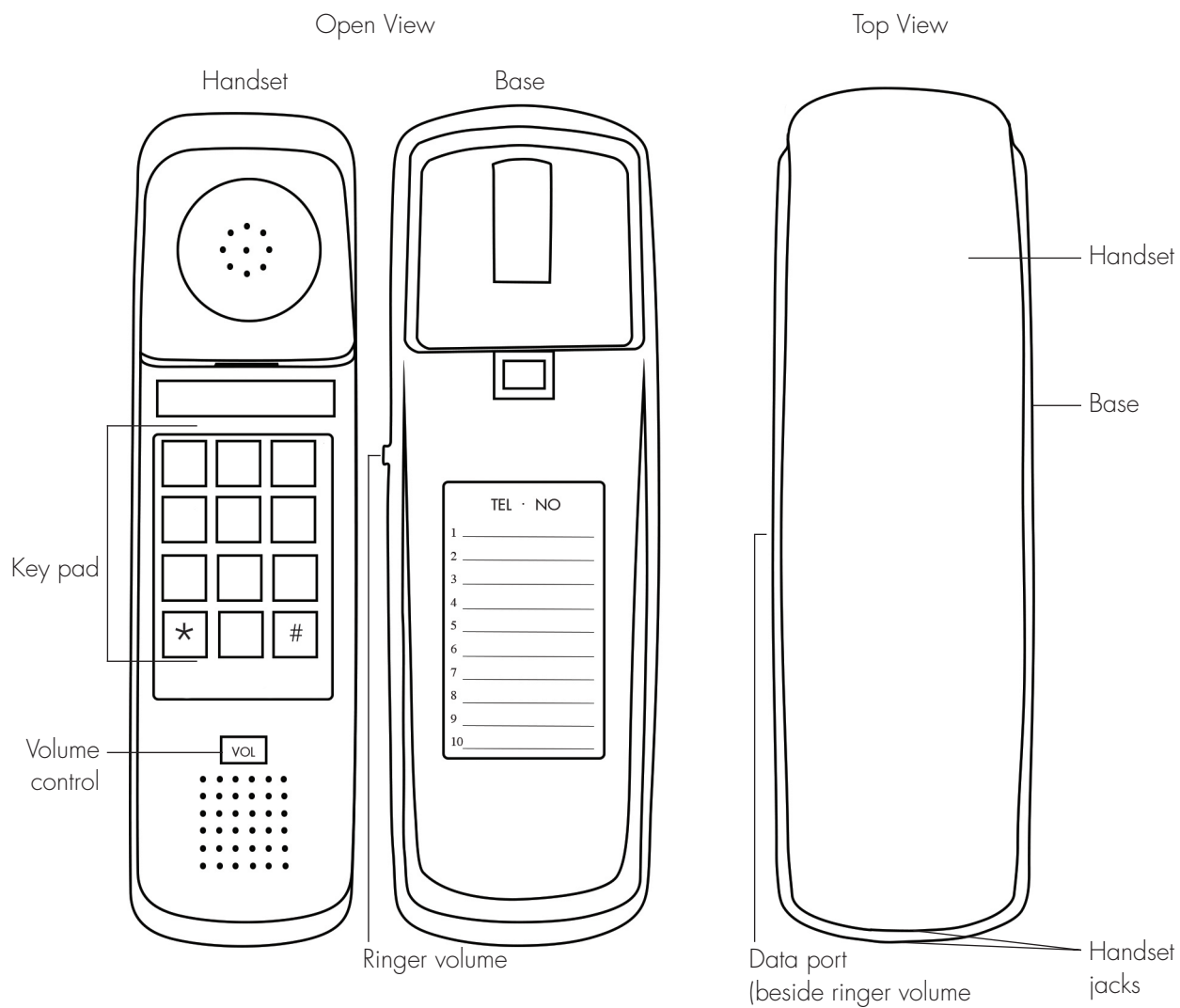

EH2000 Cradle Phone Map

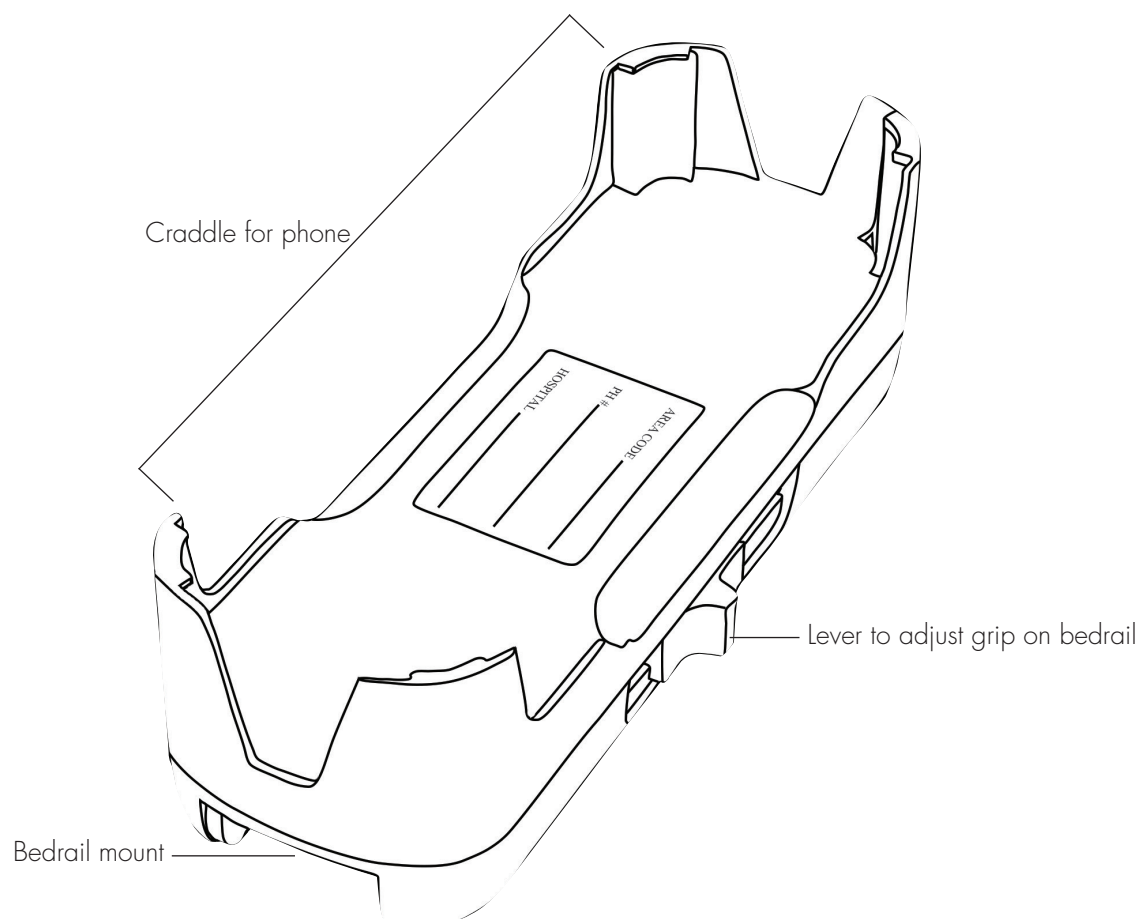

H2000VRI Phone in EH2000 Cradle Mounted on Bedrail



H2001-09 Phone Map

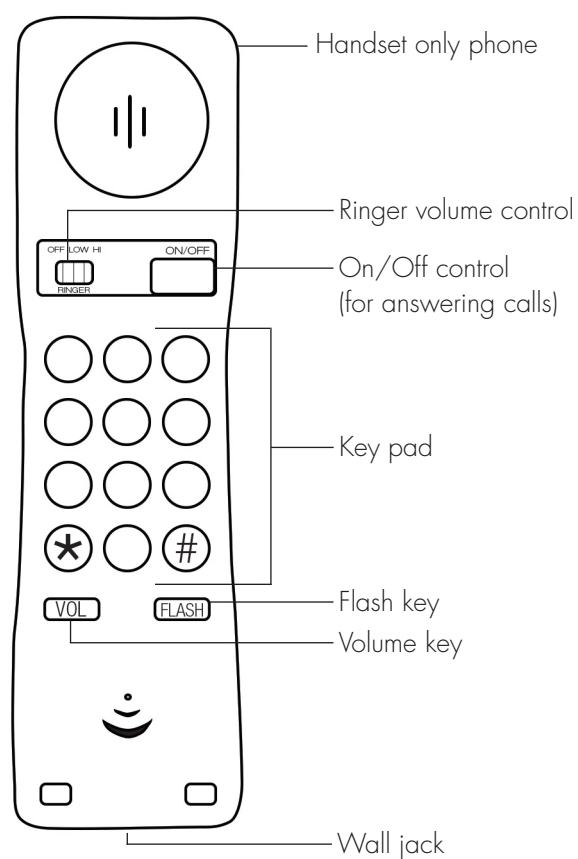

H2001-00 Phone Map

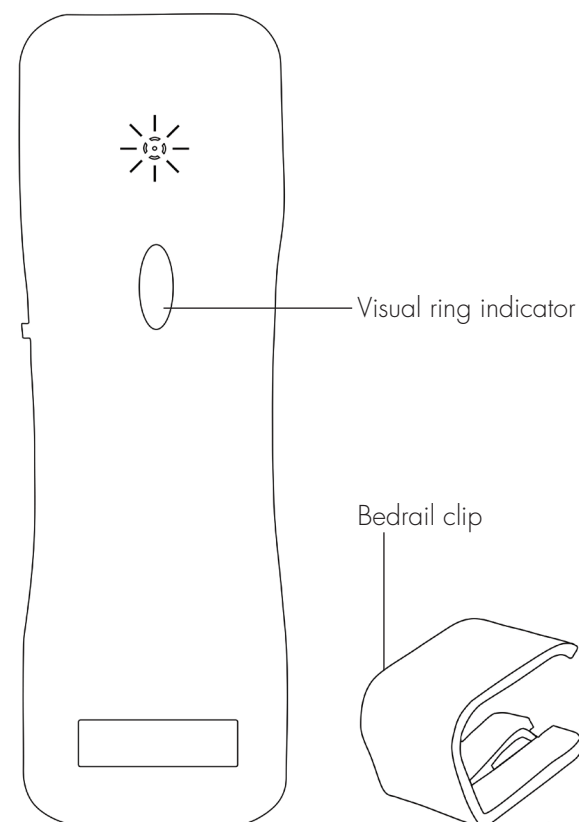
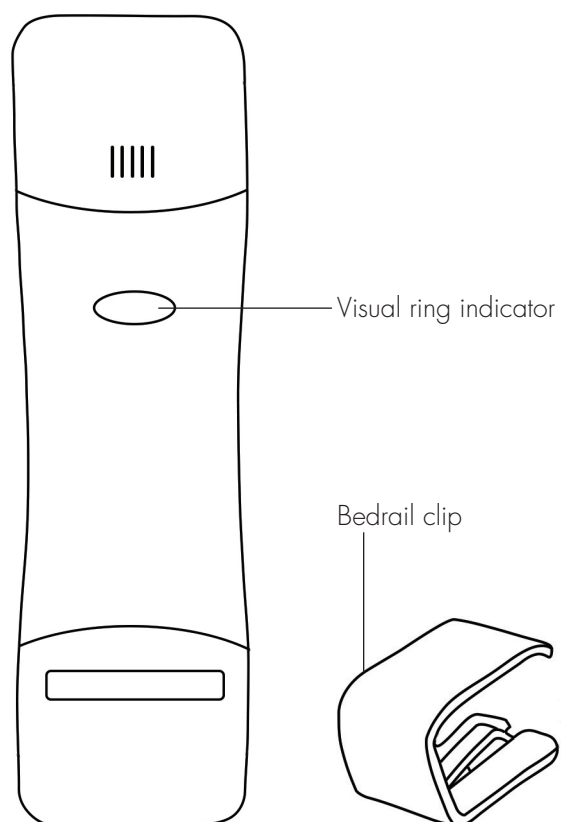
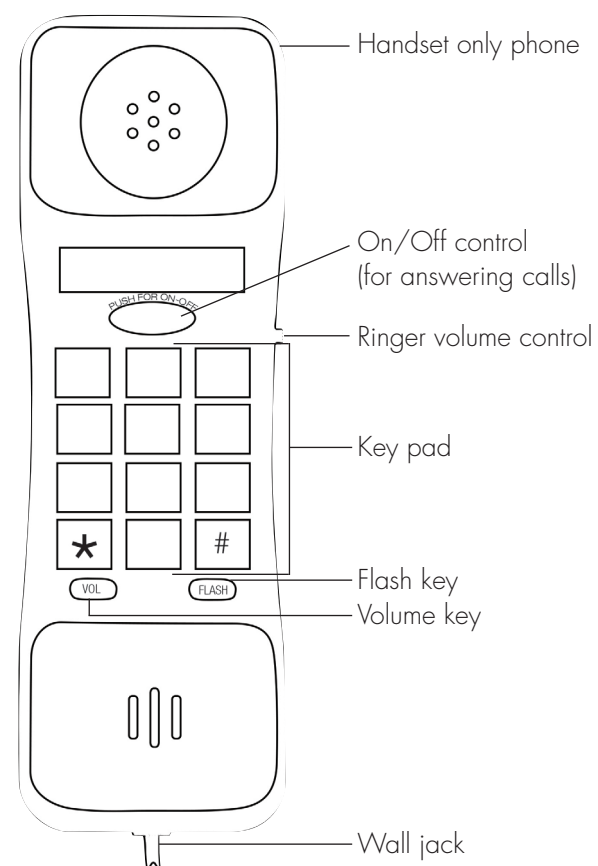

This telephone user guide details installation, programming, and operation instructions for Scitec healthcare telephones. Please refer to the Scitec website (www.scitecinc.com) for updates to these and other Scitec products.

H2000VRI/H2000

Package Contents

- Telephone base unit
- Telephone handset unit
- Coiled handset cord
- Straight line cord

Installation

Each healthcare telephone is designed for use behind a registered PBX system. The telephone user or system installer must supply an RJ-11 modular wall jack to connect this telephone to the PBX system. The PBX station port type must be Industry Standard Analog or POTS. This telephone cannot be used with digital PBX station ports. Insert one end of the coiled handset cord into the jack on the **BOTTOM END** of the base unit. Insert the other end of the cord into the jack on the **BOTTOM END** of the handset. The handset of the unit should now be placed into the base of the unit. Connect the straight line cord from the wall jack to one of the line jack located underneath the base unit. Lift the handset. A dial tone should be heard in the receiver.

Attaching the Handset

Connect the supplied coiled handset cord between the jack on the end of handset and the jack marked with a handset symbol on the left side of the telephone base unit. Place the handset on the telephone base unit or if wall-mounted, hang it on the desk/wall-mount clip to depress the hook switch.

Wall-Mounting

- The wall/desk handset clip located on the front of the phone. In its wall-mount position, the clip extends up to hold the handset in place. Gently pull it up and turn half a turn to change from desk to wall mount. This clip is spring-loaded and not removable, so that it cannot be lost.
- Turn the telephone over so the telephone face is down.
- Connect line cord to the jack on rear of phone.
- Hold telephone in front of the two mushroom shaped mounting posts on the wall jack plate. Line up keyholes on wall-mounting bracket with posts. After engaging wall-mounting bracket with posts, slide telephone down slightly. When properly installed, the telephone will be firmly attached to the wall.

Operation

RINGER VOLUME—Adjusts ringer volume to LOW or HI. Located on the left side of the phone near the data port.

HEARING AID-COMPATIBLE HANDSET—ADA/HAC-compatible.

HANDSET JACK—Modular jack to connect coiled handset cord from handset to base unit.

DATA PORT—Provides access to the telephone line for optional connection of modem, fax, or answering machine. Located on the left side of the phone near the ringer control.

DIALING KEYS—0–9 dialing keys.

VOLUME SWITCH—Volume control switch on the handset steps through the three available handset volume levels [Normal to Medium to High].

VISUAL RINGING INDICATOR—Indicates phone is ringing or a message is waiting. Responds to NEON/90V message waiting light format. (H2001VRI model only.)

To Place a Call

Lift the handset, then dial the number desired.

To Answer a Call

Lift the handset.

Adjusting Handset Volume

Press the [VOL] key. Each press of [VOL] moves to the next of three possible settings of [Low to Medium to High], and repeats back to Low volume on the forth press. Adjust as desired.

Adjusting Ringer Volume

The ringer volume control switch is located on the left side of the telephone. There are two ringer volume settings, high and low. Adjust as desired.

Jacks

A plug and jack used to connect this equipment to the premises wiring and telephone network must comply with the applicable FCC Part 68 rules and requirements adopted by the ACTA. A compliant telephone cord and modular plug is provided with this product. It is designed to be connected to a compatible modular jack that is also compliant.

EH2000

Bedrail Holder

The EH2000 bedrail holder fits most hospital bedrails. It has a convenient side mount slide lever to secure the holder to the bedrail.

H2001-09/H2001-00

Package Contents

- Telephone
- Straight line cord
- Clip (for attaching telephone to a bed rail)

Operation

Placing a Call

Press the [PUSH FOR ON-OFF] key, then dial number as desired. The visual ring indicator will turn green to indicate the phone is off-hook.

Taking a Call

Press the [PUSH FOR ON-OFF] key. While the phone is ringing, the visual ring indicator will flash red. The visual ring indicator will turn solid green when the phone has been answered.

Adjusting Phone Volume

Press the [VOL] key, each press steps through the volume settings of [Low to Medium to High to Low]. Adjust as desired.

Ringer Volume Control

Slide the [Off-Low-Hi] volume switch to adjust ringer volume. In all ringer modes, ringing will be accompanied by a flashing light on the telephone.

Flash Key

Enters a 600 ms hook switch flash for accessing special telephone system features.

Lighted Keypad

0-9, *, and # dialing keys are illuminated for low light conditions.

Jacks

A plug and jack used to connect this equipment to the premises wiring and telephone network must comply with the applicable FCC Part 68 rules and requirements adopted by the ACTA. A compliant telephone cord and modular plug is provided with this product. It is designed to be connected to a compatible modular jack that is also compliant.

Important Safety Instructions

When using your telephone equipment, basic safety precautions should always be followed to reduce the risk of fire, electric shock, and injury to persons, including the following:

1. Read and understand all instructions.
2. Follow all warnings and instructions marked on the product.
3. Unplug the product from the wall outlet before cleaning. Do not use liquid cleaner or aerosol cleaners. Use a damp cloth for cleaning.
4. Do not use this product near water—for example, near a bathtub, wash bowl, kitchen sink or laundry tub, in a wet basement, or near a swimming pool.
5. Do not place this product on an unstable cart, stand, or table. The product may fall, causing serious damage to the product.
6. Slots and openings in the cabinet and the back or bottom are provided for ventilation, to protect it from overheating. These openings must not be blocked or covered. The openings should never be blocked by placing the product on the bed, sofa, rug, or any other similar surface. This product should never be placed near or over a radiator or heat register. This product should not be placed in a built-in installation unless proper ventilation is provided.
7. Never push objects of any kind into this product through cabinet slots as they may touch dangerous voltage points or short out parts that could result in a risk of fire or electric shock. Never spill liquid of any kind on the product.
8. To reduce the risk of electric shock do not disassemble this product. Take it to a qualified service facility if service or repair work is required. Opening or removing covers may expose you to dangerous voltages or other risks. Incorrect reassembly

can cause electric shock when the appliance is subsequently used.

9. Unplug this product from the wall outlet and refer servicing to qualified service personnel under the following conditions:
 - When the power supply cord or plug is damaged or frayed.
 - If liquid has been spilled into the product.
 - If the product has been exposed to rain or water.
 - If the product does not operate normally by following the operating instructions. Adjust only those controls that are covered by the operating instructions, as improper adjustment of other controls may result in damage and may require extensive work by a qualified technician to restore the product to normal operation.
 - If the product has been dropped or the cabinet has been damaged.
 - If the product exhibits a distinct change in performance.
10. Avoid using a telephone (other than a cordless type) during an electrical storm. There may be a remote risk of electric shock from lightning.
11. Do not use the telephone to report a gas leak in the vicinity of the leak.

PLEASE SAVE THESE INSTRUCTIONS.

FCC Interference Information

This device complies with Part 15 of the FCC Rules. Operation is subject to the following two conditions:

1. This device may not cause harmful interference.
2. This device must accept any interference received, including interference that may cause undesired operation.

This equipment has been tested and found to comply with the limits for a Class B digital device, pursuant to Part 15 of the FCC Rules. These limits are designed to provide reasonable protection against harmful interference in a residential installation. This equipment generates, uses, and can radiate radio frequency energy and, if not installed and used in accordance with the instructions, may cause harmful interference to radio communications. However, there is no guarantee that interference will not occur in a particular installation.

If this equipment does cause harmful interference to radio or television reception, which can be determined by turning the equipment off and on, the user is encouraged to try to correct the interference by one or more of the following measures:

- Reorient or relocate the receiving antenna for the radio or television that is receiving the interference).
- Reorient or relocate and increase the separation between the telecommunications equipment and receiving antenna.
- Connect the telecommunications equipment into an outlet on a circuit different from that to which the receiving antenna is connected.

FCC RF Radiation Exposure Statement

The installation of the base unit should allow at least 20 centimeters between the base and persons to be in compliance with FCC RF exposure guidelines. For body-worn operation, the portable part (handset) has been tested and meets FCC RF exposure guidelines.

This device must not be co-located or operating in conjunction with any other antenna or transmitter. The changes or modifications not expressly approved by the party responsible for compliance could void the user's authority to operate the equipment.

Industry of Canada Requirements

Note: This equipment meets the applicable Industry Canada Terminal Equipment Technical Specifications. This is confirmed by the registration number. The abbreviation, IC, before the registration number signifies that registration was performed based on a Declaration of Conformity indicating that Industry Canada technical specifications were met. It does not imply that Industry Canada approved the equipment.

Before installing this equipment, users should ensure that it is permissible to be connected to the facilities of the local telecommunications company. The equipment must also be installed using an acceptable method of connection. The customer should be aware that compliance with the above conditions may not prevent degradation of service in some situations.

Repairs to certified equipment should be coordinated by a representative designated by the supplier. Any repairs or alterations made by a user to this equipment, or equipment malfunctions, may give the telephone communications company cause to request the user to disconnect the equipment.

Users should ensure for their own protection, that the electrical ground connections of the power utility, telephone lines, and internal metallic water pipe system, if present, are connected together. This precaution may be particularly important in rural areas.

Caution: Users should not attempt to make such connections themselves, but should contact the appropriate electric inspection authority, or electrician, as appropriate.

Notice: The Ringer Equivalence Number (REN) assigned to each terminal device provides an indication of the maximum number of terminals allowed to be connected to a telephone interface. The termination on an interface may consist of any combination of devices subject only to the requirement that the sum of the Ringer Equivalence Numbers of all the devices does not exceed 5.

REN: Z

For warranty and service in Canada, please contact:

Williams Telecommunications
5610 Kennedy Road
Mississauga, Ontario, L4Z2A9 Canada
Phone: 905-712-4242
Fax: 905-712-1754

Requirements of Part 15— FCC Rules

Note: This equipment has been tested and found to comply with the limits for a Class B digital device, pursuant to Part 15 of the FCC Rules. These limits are designed to provide reasonable protection against harmful interference in a residential installation. This equipment generates, uses, and can radiate radio frequency energy and, if not installed and used in accordance with the instructions, may cause harmful interference to radio communications. However, there is no guarantee that interference will not occur in a particular installation. If this equipment does cause harmful interference to radio or television reception, which can be determined by turning the equipment off and on, the user is encouraged to try to correct the interference by one or more of the following measures:

1. Move the telephone away from the receiver.
2. Consult the dealer or an experienced radio/TV technician for help.

Any changes made by the user not approved by the manufacturer can void the user's authority to operate the telephone.

Requirements of Part 68— FCC Rules

This equipment complies with Part 68 of the FCC Rules and the requirements adopted by ACTA. On the bottom of this telephone is a label that contains, among other information, a product identifier in the format US:AAAEQ##TXXXX. If

requested, this number must be provided to the telephone company. The USOC Jack for this equipment is RJ11C.

A plug and jack used to connect this equipment to the premises wiring and telephone network must comply with the applicable FCC Part 68 rules and requirements adopted by ACTA. A compliant telephone cord and modular plug are provided with this telephone. It is designed to be connected to a compatible modular jack that is also compliant. See installation instructions for details.

The Ringer Equivalence Number (REN) is used to determine the number of devices that may be connected to a telephone line. Excessive RENs on a telephone line may result in the devices not ringing in response to an incoming call. In most but not all areas, the sum of RENs should not exceed five (5.0). To be certain of the number of devices that may be connected to a line, as determined by the total RENs, contact the local telephone company. For products approved after July 23, 2001, the REN for this product is a part of the product identifier that has the format US:AAAEQ##TXXXX. The digits represented by ## are the REN without a decimal point (e.g., 03 is a REN of 0.3). For earlier products, the REN is separately shown on the label.

If this telephone causes harm to the telephone network, the telephone company will notify you in advance that temporary discontinuance of service may be required. But if advance notice is not practical, the telephone company will notify the customer as soon as possible. Also, you will be advised of your right to file a complaint with the FCC if you believe it is necessary.

The telephone company may make changes in its facilities, equipment, operations, or procedures that could affect the operation of the equipment. If this happens, the telephone company will provide advance notice in order for you to make the necessary modifications to maintain uninterrupted service.

If trouble is experienced with this equipment, for repair or warranty information, please contact Cetis at +1-719-638-8821. If the equipment is causing harm to the telephone network, the telephone company may request that you disconnect the equipment until the problem is resolved.

There are no user-serviceable parts contained in this equipment.

Connection to party line service is subject to state tariffs. Contact the state public utility commission, public service commission, or corporation commission for information.

If your home has specially wired alarm equipment connected to the telephone line, ensure the installation of this product does not disable your alarm equipment. If you have questions about what will disable alarm equipment, consult your telephone company or a qualified installer.

This telephone is hearing aid compatible.

These telephone devices are intended for commercial use only, primarily in hotel guestrooms. They must be used with a PBX (private branch exchange), and are not intended to be connected directly to a PSTN line (public switched telephone network). There are no user-serviceable parts inside the equipment.

Care and Maintenance

- **Keep the telephone dry.** If it gets wet, wipe it dry immediately. Liquids might contain minerals that can corrode the electronic circuits.
- **Use and store the telephone in a normal temperature environment.** Temperature extremes can shorten the life of electronic devices and distort or melt parts.
- **Keep the telephone away from excessive dust and dirt** which can cause premature wear of parts.

- **Wipe the telephone with a damp cloth** occasionally to keep it looking new. Do not use harsh chemicals, cleaning solvents, or strong detergents to clean the system.

Technical Specifications

This guide covers product made from 2009 forward with a serial number beginning with XX. For all other models please refer to the Scitec website for legacy product documentation.

Dimensions

9.0"(l) x 4.0"(w) x 4.0"(h) (H2000VRI/H2000)

9.0"(l) x 4.0"(w) x 4.0"(h) (EH2000)

8.25"(l) x 2.25"(w) x 1.5"(h) (H2001-09)

8.25"(l) x 2.5"(w) x 2.0"(h) (H2001-00)

Weight

Master Pack Quantities of 16 Units:

32 lbs/14.51 kg (H2000VRI, H2000, EH2000, H2001-09, H2001-00)

User Guides

If additional User Guides are needed, please go to www.scitecinc.com to download the PDF.

Service

When problems arise that cannot be resolved using this or related documents, please go to www.scitecinc.com/support for information about customer support, technical support, warranty, and product returns.

Statement of Limited Warranty

Scitec product warranty information is available at www.scitecinc.com.



U.S. Toll Free 1 800 794 8353
Telephone +1 719 638 8821
Fax +1 719 638 8757

info@scitecinc.com
scitecinc.com

SCITEC®